

Using: **Locally grown constructions- material:** Bamboo or wooden rods



Earthquake and storm- proof

Because the choice of immovable triangle as a structural design element being chosen.

Making possible by newly developed and patented connection fittings.

Connection fittings works for naturally grown and not treated bamboo or wooden rods various diameter. Or plastic pipes reinforced.



Normalized inside-fitting:

Filler by means of synthetic resin

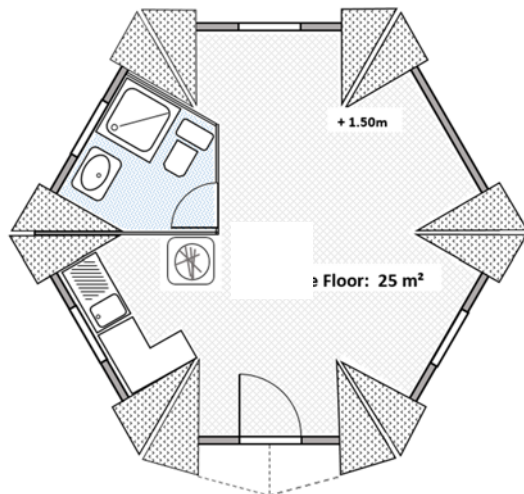

The normalized Bamboo - House thoughtful in detail. Dimensioned and defined construction components. Prefabricated by local persons under instruction by The Swiss NPO: Swiss Expert Corps or other practice oriented individuals.

Exposed or cold zones: Agent wood layer board covered with rigid polyurethane foam to fully:

Heat and water insulation.

The foundation by wooden piles, chengal wood or similar. Or by means of masonry or not reinforced on site concrete. For installation using local available or imported material.

Temperate or warm zones: Same as above, roofing with or without wood layer boards, covered with straw, - or reed, - or palm branches, - or bamboo grass, or tarpaulins.

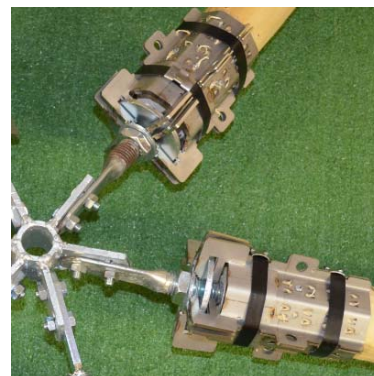

Normalized Outside-Fitting

No filler at all, cuff with thorns only